

Highways Act 1980 Section 119

Nottingham City Council

(Part of Footpath 28 Nottingham Midland Station)

Diversion Order 2014 (DO5016)

Proposed Diversion of Part of Footpath 28

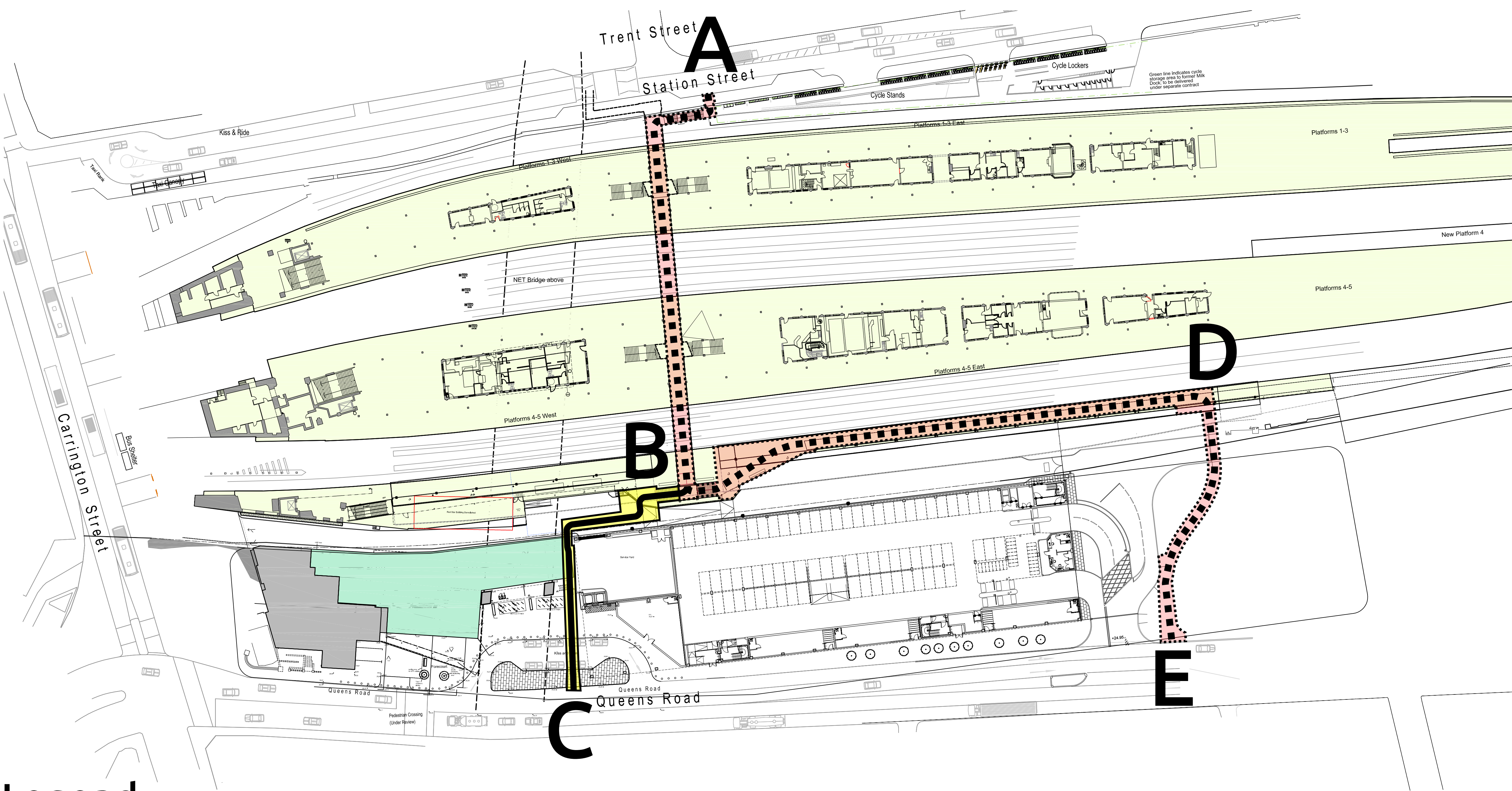

Legend

- A—B—C Footpath 28 subject of diversion order
- A—B—D—E Newline of Footpath 28
- B—C part of Footpath 28 to be stopped up and diverted onto a new line
- A—B part of Footpath 28 not affected by diversion order

SCALE:
1:1000 @ A3
1:1414 @ A4

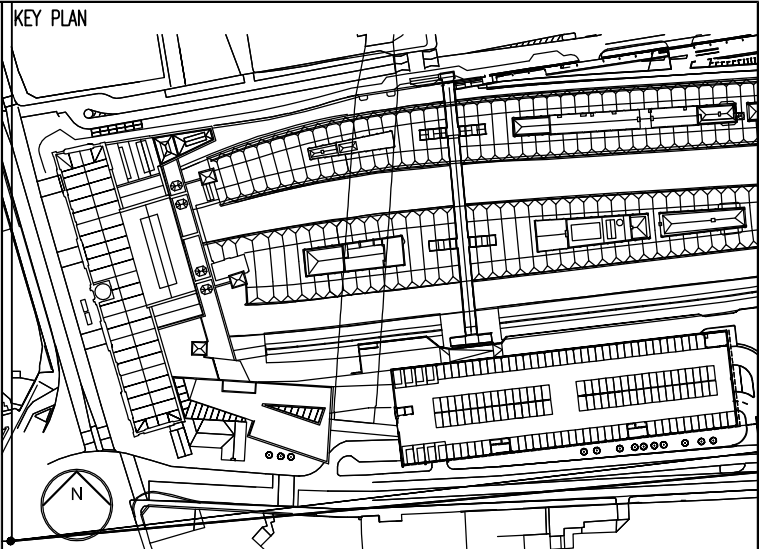
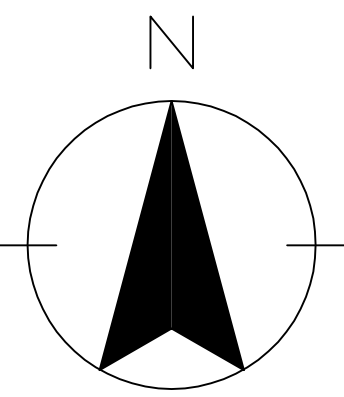

SAFETY HEALTH AND ENVIRONMENTAL INFORMATION BOX	
Potential Risks	

In addition to the hazard/risks normally associated with the types of work detailed on this drawing take note of the above.
This drawing is to be read in conjunction with the relevant Design Risk Assessment and the Contractor's Risk Register.
Reference should also be made to the Construction Phase Health and Safety Plan, prepared and maintained by the Principal Contractor.
It is assumed that all works on this drawing will be carried out by a competent contractor working, where appropriate, to an appropriate method statement.

- NOTES
1. The general contractor is responsible for the verification of all dimensions on site and the architect is to be informed of any discrepancy. Do not scale from this drawing. Use figured dimensions only.
 2. The signed control copy of this drawing is held at the offices of Pascall+Watson Limited.
 3. All existing building dimensions and levels taken from survey information unless stated otherwise.

Revised as requested									
P04	GP	06.12.12	BB	06.12.12	MH	06.12.12			
Revised as requested									
P03	GP	05.12.12	BB	05.12.12	MH	05.12.12			
Revised as option 1									
P02	GP	07.08.12	BB	07.08.12	MH	07.08.12			
ISSUED FOR INFORMATION									
P01	GP	07.08.12	BB	07.08.12	MH	07.08.12			
COMMENT									
REV	DRAWN BY	D_DATE	CHECKED BY	C_DATE	APPROVED BY	A_DATE			
	GP		RC		MH	03.08.12			
SCALES @ A1	ISSUING OFFICE	PROJECT NUMBER							
	PWA	4168							

PURPOSE OF ISSUE
FOR INFORMATION

Taylor Woodrow Construction Ltd
Astral House
Imperial Way
Watford
Hertfordshire
WD24 4VW
Tel: +44 (0)1923 233433
<http://www.taylorwoodrow.com>

PROJECT
NOTTINGHAM STATION

TITLE
TOWN AND COUNTRY PLANNING ACT 1990 SECTION 257
NOTTINGHAM CITY COUNCIL
(PART OF FOOTPATH 28 NOTTINGHAM MIDLAND STATION)
DIVERSION ORDER 2012 (DO5016)



Architect
Pascall+Watson architects
5 Carlson Court, 116 Putney Bridge Road, London SW15 2NQ
Telephone +44 (0)20 8874 1511
Facsimile +44 (0)20 8874 2584
www.pascalls.co.uk
This drawing is issued on behalf of Pascall+Watson architects Limited.

DRAWING NUMBER	REV
VA0008-PWA-SKT-GEN-AR-310003	P04